

GLADSUM 东莞市欣永电子科技有限公司 规格标准书

COMPONENT SPECIFICATION

版次:第2版

NAME	SMD POWER INDUCTORS PK Series	COMPOSITE SPECIFICATION		1/2
		SPEC#	PK1012 Series	

◆ Dimensions (mm)

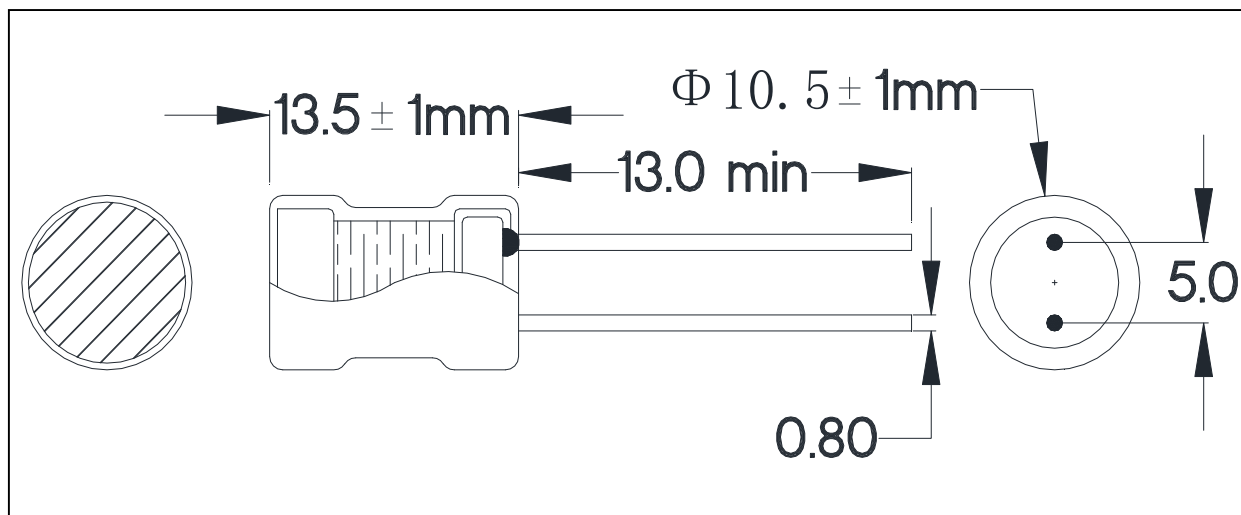

◆ SCHEMATIC DIAGRAM:

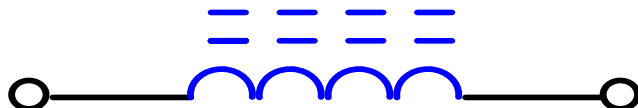

◆ Description

- Ferrite drum core construction.
- Enamelled copper wire : F class
- Products comply with RoHS' requirements
- Halogen free available

◆ GENERAL SPECIFICATION

- Temp. rise : 20°C max. at rated current.
- Storage temp. : -40°C ---- +125°C
- Operating temp. : -40°C---- +125°C
(Temp.rise included)



HISTORY	DATE	REVISION	SIGN.	SIGN.
PLANNED BY	CHECKED BY	APPROVED BY		
JSHING	SLEKEY	table zhu		

GLADSUM 东莞市欣永电子科技有限公司 规格标准书

COMPONENT SPECIFICATION

版次:第2版

NAME	SMD POWER INDUCTORS	COMPOSITE SPECIFICATION		2 / 2
	PK Series	SPEC#	PK1012 Series	

◆ Specification

Part Name	Stamp	Inductance [Within] (μ H)※1	D.C.R (Ω)[Max.] (at 20°C)	Rated Current (A)	Test Freq. (KHz)
PK1012-1R0M	1R0	1 \pm 10%	0.010	6.00	1.00
PK1012-1R5M	1R5	1.5 \pm 10%	0.010	6.00	1.00
PK1012-1R8M	1R8	1.8 \pm 10%	0.015	6.00	1.00
PK1012-2R7M	2R7	2.7 \pm 10%	0.015	5.50	1.00
PK1012-3R3M	3R3	3.3 \pm 10%	0.020	5.50	1.00
PK1012-3R9M	3R9	3.9 \pm 10%	0.020	5.00	1.00
PK1012-4R7M	4R7	4.7 \pm 10%	0.025	5.00	1.00
PK1012-5R6M	5R6	5.6 \pm 10%	0.025	4.80	1.00
PK1012-6R8M	6R8	6.8 \pm 10%	0.025	4.80	1.00
PK1012-8R2M	8R2	8.2 \pm 10%	0.025	4.50	1.00
PK1012-100K	100	10 \pm 10%	0.025	4.50	1.00
PK1012-120K	120	12 \pm 10%	0.025	4.30	1.00
PK1012-150K	150	15 \pm 10%	0.035	4.30	1.00
PK1012-180K	180	18 \pm 10%	0.040	4.00	1.00
PK1012-220K	220	22 \pm 10%	0.045	3.70	1.00
PK1012-270K	270	27 \pm 10%	0.045	3.50	1.00
PK1012-330K	330	33 \pm 10%	0.055	3.00	1.00
PK1012-390K	390	39 \pm 10%	0.060	2.50	1.00
PK1012-470K	470	47 \pm 10%	0.080	2.30	1.00
PK1012-560K	560	56 \pm 10%	0.085	2.00	1.00
PK1012-680K	680	68 \pm 10%	0.095	2.00	1.00
PK1012-820K	820	82 \pm 10%	0.110	1.80	1.00
PK1012-101K	101	100 \pm 10%	0.140	1.70	1.00
PK1012-121K	121	120 \pm 10%	0.160	1.50	1.00
PK1012-151K	151	150 \pm 10%	0.180	1.40	1.00
PK1012-181K	181	180 \pm 10%	0.250	1.30	1.00
PK1012-221K	221	220 \pm 10%	0.280	1.00	1.00
PK1012-271K	271	270 \pm 10%	0.420	0.90	1.00
PK1012-331K	331	330 \pm 10%	0.540	0.80	1.00
PK1012-391K	391	390 \pm 10%	0.600	0.80	1.00
PK1012-471K	471	470 \pm 10%	0.660	0.70	1.00
PK1012-561K	561	560 \pm 10%	0.740	0.60	1.00
PK1012-681K	681	680 \pm 10%	0.840	0.50	1.00
PK1012-821K	821	820 \pm 10%	1.080	0.50	1.00
PK1012-102K	102	1000 \pm 10%	1.390	0.50	1.00

◆ Part Numbering System

PK - 1012 - 100 - K - U - LF
 1 2 3 4 5 6

- 1、 Series name: PK series name
- 2、 Dimensions:1012=10.5*13.5
- 3、 inductnace: 1R0=1UH、100=10UH、101=100uh
- 4、 tolerance:J: \pm 5%、K: \pm 10%、L: \pm 15%、M: \pm 20%、P: \pm 25%、N: \pm 30%
- 5、 Packingcode: UL&PVC
- 6、 Lead Free