

GLADSUM 东莞市欣永电子科技有限公司 规格标准书

COMPONENT SPECIFICATION

版次:第2版

NAME	SMD POWER INDUCTORS CDRH Series	COMPOSITE SPECIFICATION		1/2
		SPEC#	CDRH1207 Series	

◆ Product Description

- 12.3×12.3mm Max.(L×W),8.0mm Max. Height.
- Both standard type CDRH1207
- Rated current range:0.24~2.6A(at20°C)
- Inductance Range:1.2μH~1.0mH
- Rated current range:0.55~9.8A
- In addition to the standard versions of inductors shown here, custom inductors are available to meet your exact requirements.



◆ Feature

- Magnetically unshielded construction.
- Ideally used in Mobilephone,PDA,MP3,DSC/DVC,HDD,Portable DVD,etc as DC-DC Converter inductors.
- RoHS Compliance and Halogen free.

◆ Dimensions (mm)

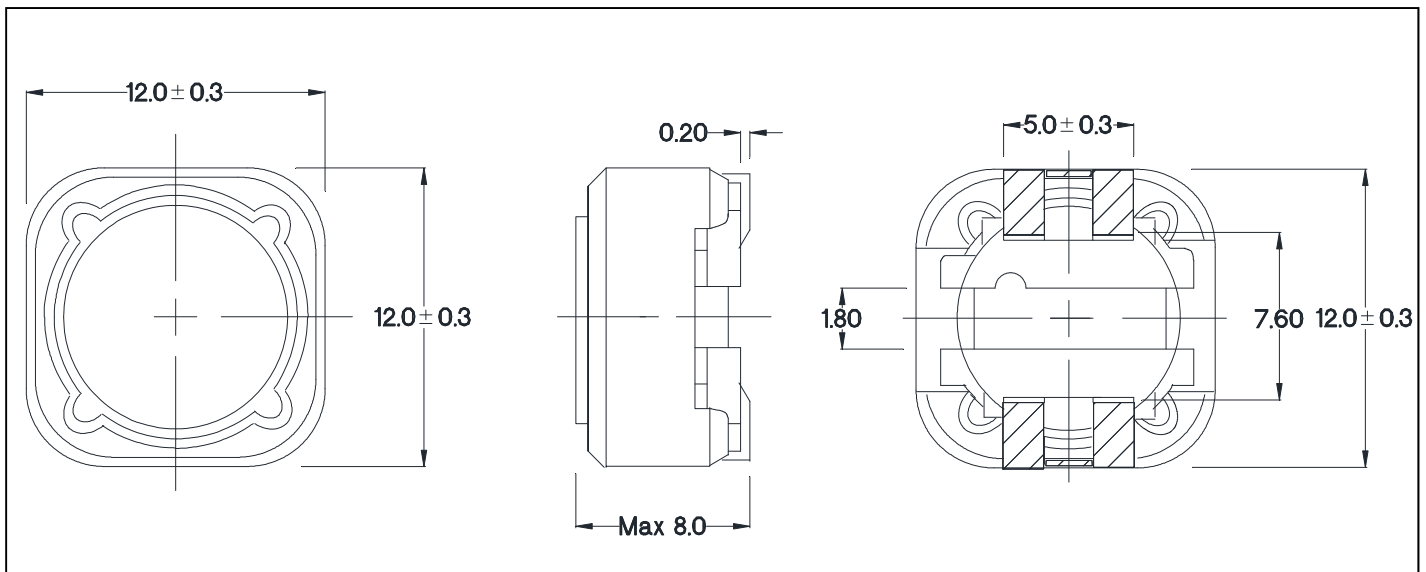

HISTORY	DATE	REVISION	SIGN.	SIGN.
PLANNED BY	CHECKED BY	APPROVED BY		
JSHING	SLEKEY	table zhu		

GLADSUM 东莞市欣永电子科技有限公司 规格标准书

COMPONENT SPECIFICATION

版次:第2版

NAME	SMD POWER INDUCTORS CDRH Series	COMPOSITE SPECIFICATION		2 / 2
		SPEC#	CDRH1207	

◆ Specification

Part Name	Stamp	Inductance [Within] (μ H) ※1	D.C.R (m Ω)[Max.] (at 20°C)	Rated Current (A) ※2	Measuring frequency
CDRH1207-1R2N	1R2	1.2 \pm 30%	7.00	9.80	100k
CDRH1207-2R4N	2R4	2.4 \pm 30%	11.50	8.00	100k
CDRH1207-3R5N	3R5	3.5 \pm 30%	13.50	7.50	100k
CDRH1207-4R7N	4R7	4.7 \pm 30%	15.80	6.80	100k
CDRH1207-6R1N	6R1	6.1 \pm 30%	17.60	6.60	100k
CDRH1207-7R6N	7R6	7.6 \pm 30%	20.00	5.90	100k
CDRH1207-100M	100	10 \pm 20%	21.60	5.40	1K
CDRH1207-120M	120	12 \pm 20%	24.30	4.90	1K
CDRH1207-150M	150	15 \pm 20%	27.00	4.50	1K
CDRH1207-180M	180	18 \pm 20%	39.20	3.90	1K
CDRH1207-220M	220	22 \pm 20%	43.20	3.60	1K
CDRH1207-270M	270	27 \pm 20%	45.90	3.40	1K
CDRH1207-330M	330	33 \pm 20%	64.80	3.00	1K
CDRH1207-390M	390	39 \pm 20%	72.90	2.75	1K
CDRH1207-470M	470	47 \pm 20%	0.10	2.50	1K
CDRH1207-560M	560	56 \pm 20%	0.11	2.35	1K
CDRH1207-680M	680	68 \pm 20%	0.14	2.10	1K
CDRH1207-820M	820	82 \pm 20%	0.16	1.95	1K
CDRH1207-101M	101	100 \pm 20%	0.22	1.70	1K
CDRH1207-121M	121	120 \pm 20%	0.25	1.60	1K
CDRH1207-151M	151	150 \pm 20%	0.28	1.42	1K
CDRH1207-181M	181	180 \pm 20%	0.35	1.30	1K
CDRH1207-221M	221	220 \pm 20%	0.39	1.16	1K
CDRH1207-271M	271	270 \pm 20%	0.56	1.06	1K
CDRH1207-331M	331	330 \pm 20%	0.64	0.95	1K
CDRH1207-391M	391	390 \pm 20%	0.70	0.88	1K
CDRH1207-471M	471	470 \pm 20%	0.98	0.79	1K
CDRH1207-561M	561	560 \pm 20%	1.07	0.73	1K
CDRH1207-681M	681	680 \pm 20%	1.46	0.67	1K
CDRH1207-821M	821	820 \pm 20%	1.64	0.60	1K
CDRH1207-102M	102	1000 \pm 20%	1.82	0.55	1K

◆ Part Numbering System

CDRH - 1207 - 100 - M - T - LF
 1 2 3 4 5 6

- 1、 Series name: CD series name
- 2、 Dimensions:1207 =12*12*7
- 3、 inductnace: 1R0=1UH、100=10UH、101=100uH
- 4、 tolerance:J: \pm 5%、K: \pm 10%、L: \pm 15%、M: \pm 20%、P: \pm 25%、N: \pm 30%
- 5、 Packingcode: Tape&Ree;In Bulk
- 6、 Lead Free